



# Jennings Firearms, Inc.

4510 CARTER COURT, CHINO, CA 91710

## MODEL J-22



**VERY IMPORTANT!**

THESE INSTRUCTIONS SHOULD BE CAREFULLY READ AND NOTED.

---

---

**ALL FIREARMS ARE DANGEROUS  
PLEASE BE CAREFUL**

We strongly advise that you familiarize yourself with all the mechanism of this, or any gun, before putting any ammunition into it.

*We provide reasonable care in the manufacture of this pistol, but assume no responsibility for its care, handling and use.*

*Never place your finger on the trigger unless you are ready to shoot the pistol.*

**SAFETY:** The Safety is conveniently located in the top of the left-hand grip. By sliding the Safety forward as far as possible to the letter "F", the pistol is in "firing" position. By sliding the Safety fully to the rear of the pistol, the letter "S" will indicate the pistol is in "safe" position. **CAUTION:** If you do not intend to shoot immediately, place the Safety in the "S" Safe position. *Do not carry with bullet in chamber.*

**LOADING THE PISTOL:** After loading your Magazine, insert it into the bottom of the pistol handle and push it into the pistol as far as possible. When fully inserted, the Magazine Catch will hook over the bottom of the Magazine and hold it in its proper position. Take the pistol in one hand with a firm grip, making sure your fingers are not touching the trigger. *Point Your Pistol in a Safe Direction* and with your other hand firmly grasp the serrated portion of the Slide and pull it as far rearward as it will go. Release the Slide allowing it to go forward of its own accord. This procedure places the first cartridge into the chamber and the gun is ready for firing. Subsequent feeding and ejection operations are performed automatically until the pistol is empty. **NOTE:** The safety must be in the "Fire" (F) position before the pistol can be cocked or loaded from the Magazine supply. *Magazine capacity-6 rounds. We recommend standard type cartridges.*

**UNLOADING WITHOUT FIRING:** Always point your pistol in a safe direction and move the Safety to Safe ("S") position before attempting to unload your pistol. To unload unfired cartridges move the Magazine Catch rearward until the Magazine can be pulled from the pistol. After the Magazine is removed, pull the Slide to the rear to remove the cartridge from the Barrel chamber. As a safety precaution, always check the Barrel chamber visually by holding the Slide back and looking into the Slide, Chamber and Magazine cavities.

**DISASSEMBLY:** *The pistol must be in unloaded, uncocked condition before take down can be performed.* To remove the Slide, use a blunt object to push the take down button, located in the back end of the Slide, forward until it stops (about 1/8 inch). While holding the take down button depressed, gently lift the Slide away from the Frame until it stops. Release the take down button gently as it is springloaded. Hold the rear of the Slide up and push the Slide forward, off of the end of the gun. This procedure removes the entire Slide Assembly and is sufficient for normal cleaning and oiling. Clean the Barrel within a reasonable period of time after shooting. After the powder residue has been removed, give the Barrel bore a light protective coat of oil.

**ASSEMBLY:** Make sure the Recoil Spring is over the barrel. Place the Slide Assembly over the Barrel and pull rearward until it can be dropped down onto the Frame. Depress the take down button into the Slide far enough to allow it to drop into its slot. Release the take down button after Slide is pushed down onto the Frame. You should not be able to lift the rear of the Slide away from the Frame if properly assembled. *After the assembly is completed, but before loading, manually operate the pistol to see that everything functions properly.*

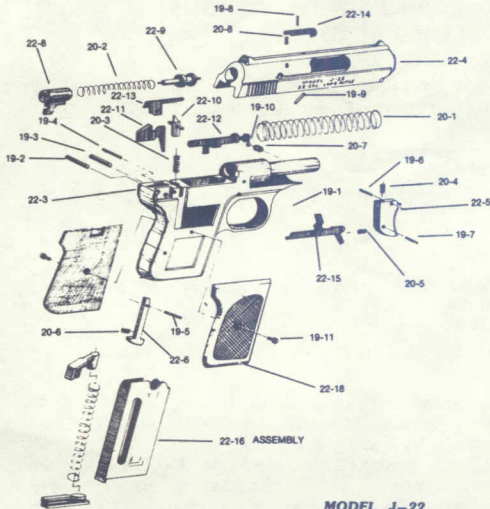

MODEL J-22

PART PRICE

J-22-3 FRAME (NOT AVAIL.)	
J-22-4 SLIDE	\$15.00
J-22-5 TRIGGER	2.00
J-22-6 CATCH	2.00
J-22-8 TAKE DOWN BUTTON	3.00
J-22-9 FIRING PIN	3.00
J-22-10 SEAR ASSEMBLY	3.00
J-22-11 CAM	2.00
J-22-12 SAFETY	2.00
J-22-13 EJECTOR	2.00
J-22-14 EXTRACTOR	2.00
J-22-15 TRIGGER BAR ASSLY	2.00
J-22-16 MAGAZINE ASSLY	10.00
J-22-18 GRIPS PAIR	PR. 4.00

J-22-19 PINS & BALL & SCREW

J-19-1 BARREL CROSS PIN	\$.50
J-19-2 TAKE DN. CROSS PIN	.50
J-19-3 CAM PIVOT PIN	.50
J-19-4 EJECTOR CROSS PIN	.50
J-19-5 CATCH CROSS PIN	.50
J-19-6 TRIGGER CROSS PIN	.50
J-19-7 TRIG. BAR CROSS PIN	.50
J-19-8 EXTRACTOR PIN	.50
J-19-9 WEAR PIN	.50
J-19-10 SAFETY BALL	.50
J-19-11 GRIP SCREWS	.50

J-22-20 SPRINGS

J-20-1 RECOIL SPRING	\$1.00
J-20-2 FIRING PIN SPRING	1.00
J-20-3 SEAR SPRING	.50
J-20-4 TRIG. RET. SPRING	.50
J-20-5 TRIG. BAR SPRING	.50
J-20-6 CATCH SPRING	.50
J-20-7 SAF. BALL SPRING	.50
J-20-8 EXTRACTOR SPRING	.50

Changes in design may occur from time to time, always specify the color of your pistol with your order.

• CAUTION •

For your safety, and that of others, we strongly recommend that you do not place a cartridge in the barrel until you are ready to shoot it. A cartridge from the Magazine supply can be placed in the barrel, ready to shoot, in about the same length of time as required to move the safety slide from the safe ("S") to the fire ("F") position.

**BE CAREFUL!!**